



BOYI 66Pro Magnetic Switch Wired Mechanical Gaming Keyboard

Quick Start Guide



Multimedia and Special Keyboard Combinatorial Functions: Windows / Mac Systems

FN+1	F1	FN+2	F2	FN+3	F3	FN+4	F4
FN+5	F5	FN+6	F6	FN+7	F7	FN+8	F8
FN+9	F9	FN+0	F10	FN+_,	F11	FN+ +=	F12
FN+L_Win	Lock Win key	FN+I	PRT	FN+O	SCR	FN+P	PAU
FN+ K	INS	FN+L	HOME	FN+,<	DELETE	FN+,>	END
FN+ESC	~ (short press)		FN+ESC	Restore factory (long press for 3 seconds)			

Home Button Area Lighting Mode

Switch Different RGB Mode: FN + PAGEDOWN

1.Wave pattern - contains six directions: left/right/up/down/gathering, spreading	8.Running mode --- contains two directions: left \ right
2.Breathing patterns.	9.Single-light mode
3.Neon Mode	10.Aurora mode - contains two directions: gathering, spreading
4.Starry Night Mode	11.Crosshair
5.Radar mode - contains two directions: forward and reverse	12.Button Response---Contains two directions: up/down
6.Normally lit mode	13.Fireworks Mode
7.Auto Ripple Mode	14.Ripple pattern

Lighting Brightness: FN + _ --- 5-level cyclic adjustment of the keyboard's lighting brightness (the function indicator flashes three times when adjusted to the maximum/minimum)

Lighting speed: FN + --- keyboard 5 levels of lighting speed cycle adjustment (adjusted to the maximum \ minimum hour function indicator flashes three times)

Change RGB Light Color Mode:FN+PAGEDOWN

Change RGB Light Color Direction:FN+|

Q:Adjusted My Keyboard then Some Keycaps types on its own or Pressing by itself?

Don't be worry! This issue caused by the trigger force of the Magnetic Switch was adjusted too low on the Software! And could solved by turning up the actuation point and rapid trigger values instead of using as low as 0.1 on the Software.

Due to the special triggering principle of the magnetic switch,the bumpy movement of the keyboard during transportation may affect the triggering accuracy.Please use 66pro software driver(<https://www.boyikeyboard.com/Software-Driver.html>) to calibrate all the keys or restore factory-in this way you can enjoy the magnetic switch's function better! This BOYI 66pro Also Support Snap Tap(SOCD) Feature

If you have any issues or concerned things,Please feel free to e-mail us: (boyiservice2020@163.com) ☺

We will take full responsible for your order!

How To Adjust The Magnetic Switch Function by using the Software Driver?

Go to BOYI Official Website to Download The Driver: <https://www.boyikeyboard.com/Download.html>

1. Normal Trigger Mode

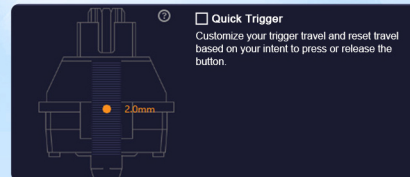

- Set the start point (2.0mm), when the key is pressed down more than 2.0mm for the key press state.
- The key release state is when the key is released to 2.0mm above the start point.

2. Quick Trigger Mode

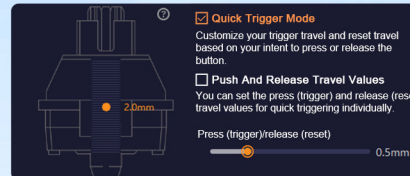

- Set the start point (2.0mm), when the key is pressed down more than 2.0mm for the key press state. The quick trigger function takes effect.
- When the key is released to more than 2.0mm above the start point, it is the key release state. The quick trigger function ends.
- When the key is in the range of 2.0mm to 4.0mm, the key is pressed down by 0.5mm for the pressed state, and the key is released by 0.5mm for the released state.

3. Rapid Trigger Mode(separate settings for press and release strokes)

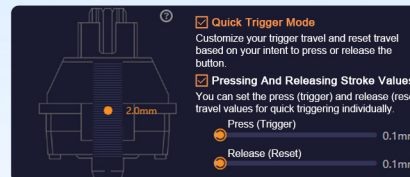

- Set the start point (2.0mm), when the key is pressed down more than 2.0mm for the key press state. The quick trigger function takes effect.
- When the key is released to the end point 2.0mm or more is the key release state. The quick trigger function ends.
- When the key is pressed down more than 2.0mm, the quick trigger function takes effect. Pressing the key downward by 0.1mm is the pressing state, and releasing the key by 0.1mm is the releasing state.